

■ SVG Fixed Straight Socket, Key(G), Front Fasten

- Connector Series: SVG
- Contact: Female
- Key: G(More keys, refer to page 43)
- Locking type: Self-locking
- Orientation type: Straight
- Part No.: SVG.xB.3xx.CLLPV
- Mated with: PSG/MSG/PLG/PPG

Note: "X" refers to part number definition on page 17

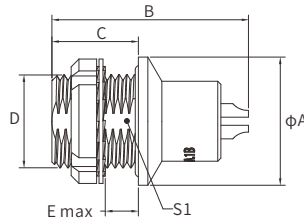

■ General Information

Ambient temperature: -20°C ~ + 100°C

Endurance: >5000 cycles

Insulator: PEEK

Connector contacts: Brass with gold plated

Coupling nut/screw: Brass with Cr plated

Housing: Brass with Cr plated

Insulator resistance: $\geq 100M\Omega$

Leakage rate(He): <10-7 mbar.l.s-1

Shielding efficiency: at 10MHz>75dB/at 1GHz>40dB

Salt spray corrosion test: >144h

Size	Dimensions(mm)					
	A	B	D	C	E	S1
00	11	18.2	M7x0.5	6.0	2.5	6.3
0B	13	20.2	M9x0.6	9.0	5.5	8.2
1B	16.5	26.6	M12x1.0	11.0	5.5	10.5
2B	20	31.6	M15x1.0	9.6	5.5	13.5

Panel cut-out (page 164)

■ FQG Six Petal Socket, Key(G), Front Fastened

- Connector series: FQG
- Contact: Female
- Key: G(More keys, refer to page 43)
- Locking type: Self-locking
- Orientation type: Straight
- Part No.: FQG.1B.3XX.CLLPV
- Mated with: PQG.1B.3XX.CLACXX(Z)

Note: "X" refers to part number definition on page 17

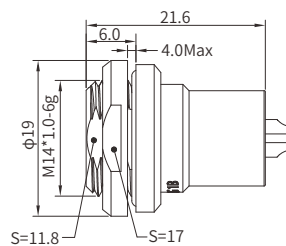

■ General Information

Ambient temperature: -20°C~+100°C

Endurance: >5000 cycles

Insulator: PEEK

Connector contacts: Brass with gold plated

Coupling nut/screw: Brass with Cr plated

Housing: Brass with Cr plated

Insulator resistance: $\geq 100M\Omega$

IP rating: IP 68

Shielding efficiency: at 10MHz>75dB/at 1GHz>40dB

Salt spray corrosion test: >144h